

# Universal remove and install sleeve kit (26pcs)

## Introduction:

- Universal application of step disc fits many kinds of different vehicles.
- Easy work to remove and install for :
  - Bearing bush
  - Silent bearing
  - Hydraulic bearing
  - Rubber bearing



## Contents:

- Spindle
- Step disc (2 pieces, each one has 2 sides as **A** & **B**)



L: 450mm spindles (with 27mm hex nut)	
M10 x P 1.5	M12 x P 1.75
M14 x P 2.0	M16 x P 2.0



Side - B

Side - A

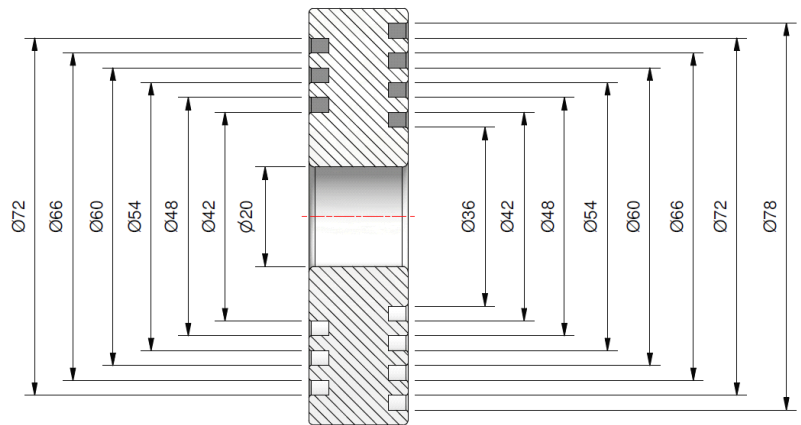

- Sleeve **A** (11 pieces) - Gold



D44 x d34
D46 x d36
D54 x d44
D56 x d46
D58 x d48
D66 x d56
D68 x d58
D70 x d60
D78 x d68
D80 x d70
D84 x d72

- Sleeve **B** ( 9 pieces )-Silver



D48 x d38
D50 x d40
D52 x d42
D60 x d50
D62 x d52
D64 x d54
D72 x d62
D74 x d64
D76 x d66

## Instruction:

Step 1: Choose an available spindle, a step disc, and a sleeve for each A & B.

Step 2: Install needed contents and choose a 27mm wrench to make removing or installing work.

*NOTE: The special U-shape hole on each sleeve helps users to see the working.*

Step 3: After work, please place tools in store case.

